



Steel Pipe Transition Fittings (Dimensions in Inches)

These steel pipe transition fittings have been used and proven for over 30 years. These parts are 100% tested after assembly and are individually serialized. They meet the applicable testing requirements of the DOT: CFR 42#192.283. The ends are ordinarily supplied as weld ends with bevel prep and external epoxy. Threaded ends are also available with either internal external epoxy coating or external epoxy coating. Design includes double O-ring seals to insure leak-tight performance. Protective sleeves are available and recommended to avoid undue soil shear at rigid tie ins.

Threaded End



Weld End

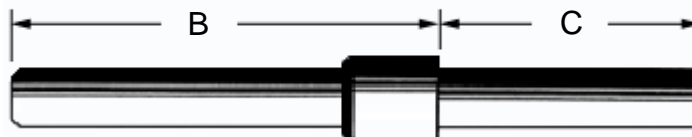

IPS Nominal Size	A (thread)	B (weld)	C (hdpe)
3/4" x 3/4"	3.9	12.9	12.0
1" x 1"	3.9	13.1	12.0
2" x 2"	3.9	13.9	12.0
3" x 3"	3.9	14.9	12.0
4" x 4"	3.9	14.9	12.0
6" x 6"	5.9	17.9	17.5

Other styles are available - Weld, MIPT, FIPT, Steel Flange and Grooved End

Other materials are available - Carbon Steel, Brass, Stainless 304&316, Epoxy Coated Call for Quick Quote for fittings that are not listed.